



separate junior area created

new toddler area created on recreation ground

Cycle track PHASE 2

new cycle track/BMX track created around the new play area with jumps and berms for children and young people to learn to ride bikes and gain BMX skills

Kick about area PHASE 2

Aim to create marked out 5 a side kick about area at north of the site

Exercise area PHASE 2

new exercise/trim trail equipment installed between junior area and kick about area with grass mat surfacing. This will cater for young people and adults

Junior Area PHASE 1

new separate junior area created using some existing equipment from original play area along with new swings and cradle swing, space for 'kerby' and zip wire. Entire area to be surfaced with sand filled carpet so there is no grass space between the units. Picnic area created between the two areas on new hard surface

Toddler Area PHASE 1

new toddler area created using some existing equipment from original play area along with new swings; new climbing frame unit and see saw. Toddler area to be fenced off, reusing the existing railings from the current play area. Entire area to be surfaced with sand filled carpet so there is no grass space between the units

Entrance PHASE 1

new gently ramped accessible entrance created to lead into new play area and wider site

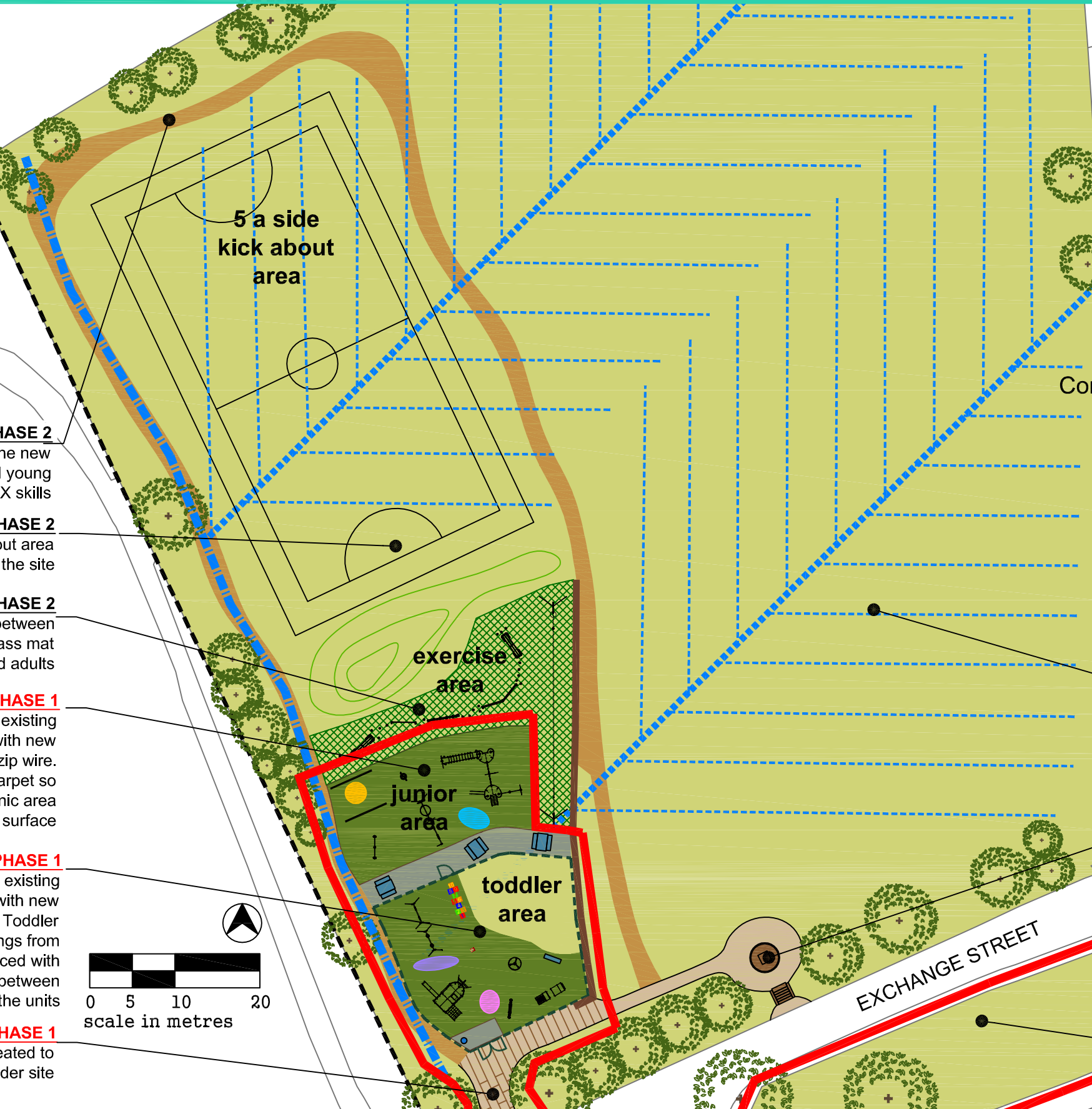
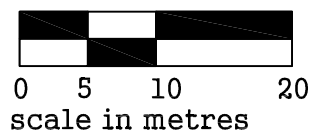

timber retaining wall around play areas



new 5 a side kick about area at north of recreation ground



water fountain turned into focal point with new paving and improved access

Recreation Ground PHASE 2

Aim to drain whole recreation ground (providing a suitable outlet can be found). Exact type of and positioning of drainage to be determined with drainage expert

Water Fountain PHASE 2

Stonework of fountain and steps to be restored/repared and new flagged surfacing laid around the fountain to create a focal point. Fountain would remain dry due to high ongoing costs involved in maintaining a working water feature

Old Play Area PHASE 1

All traces of old play area to be removed and area made good with topsoil and turf, allowing the site to be easily maintained in the future

Edenfield Play Area

Revised Proposals

September 2015

Key Points:

- new play area is smaller, taking up less space on the recreation ground
- the long term aim is to drain the whole site so it is more usable for football and for the fete
- the position of bike/BMX track has moved to create circular path around the play area

Please comment on the proposals at communities@proffittscic.com and view the plans online at <http://www.proffittscic.com/community-projects/edenfield-play-area-rossendale-lancashire/>